

STR. MELESTIU, CENTRU, CHIȘINĂU

Surface, m2

63

Rooms

2

Floor

1/10

Building type

New building

Real estate condition

White variant

Balconies

1

Heating

Autonomous

Bathrooms

1

Sale

150 000 €

Maxim Antoniu

076 097 770



Apartment for sale with 2 rooms and a living room, in a new building, located in the Centru sector, Melestiu str., exactly in Valea Trandafirilor Park.

ASTERCON construction company.

Total area: 63 m2.

Partitioning: kitchen with living room, 2 bedrooms, dressing room, sanitary block, entrance hall, balcony.

Characteristics:

- the white version;
- floor heating;
- equipped with household appliances;
- electrical wiring throughout the entire surface of the apartment;
- panoramic windows;
- autonomous heating;
- video surveillance;
- courtyard with restricted access;
- playground for children;
- location in Valea Trandafirilor park.

The courtyard of the complex is equipped with a playground for children, 24/24 security and video surveillance, and underground parking.

In the immediate vicinity you can find: Valea Trandafirilor park, Malldova, banks, beauty salons, supermarkets, kindergarten



Localizare pe hartă

STR. MELESTIU, CENTRU, CHIȘINĂU



Maxim Antoniu

076 097 770











Plan modificat

Plan original

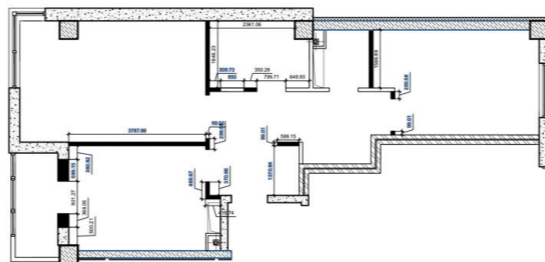
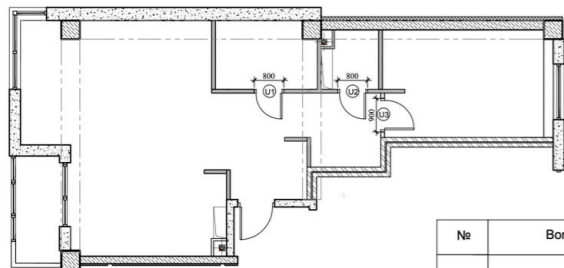

Nr	Borderou	Dimensiuni Goleului
U1	Usa cu toc ascuns Grundata : Select Doors	L=800 mm H=2100 mm
U2	Usa cu toc ascuns Grundata : Select Doors	L=800 mm H=2100 mm
U3	Usa cu toc ascuns Grundata : Select Doors	L=900 mm H=2100 mm