

**ȘOS. HÂNCEȘTI, TELECENTRU, MUN.
CHIȘINĂU**

Surface, m2
58

Floor
6/10

Real estate condition
White variant

Heating
Autonomous

Sale
79 750 €

Rooms
1

Building type
New building

Balconies
2

Bathrooms
1

Nicolae Pruteanu

079 453 777



It sells apartment with 1 room and living room with payment in installments, located in sec. Telecentru, street Hincesti.

Braus Millennium Park complex, construction company "Braus real estate".

Total area: 58.2 sqm

Partition: bedroom, living room, sanitary block, kitchen, balcony.

Features:

- White variant;
- Autonomous heating;
- The building housing is designed to withstand earthquakes up to magnitude 8 on the Richter scale, giving you Safety;
- Generous ceiling height of 3 meters;
- Warm floor ;
- Brikston red brick walls, provide durability and excellent thermal insulation;
- The windows are equipped with sound insulation and thermal efficiency, ensuring thermal comfort and reducing external noise for a quiet living;
- Ventilated facade made of tiles;
- Two-level underground parking offers enough space for all apartments;
- Block stairs are equipped with modern, fast and silent elevators, faci

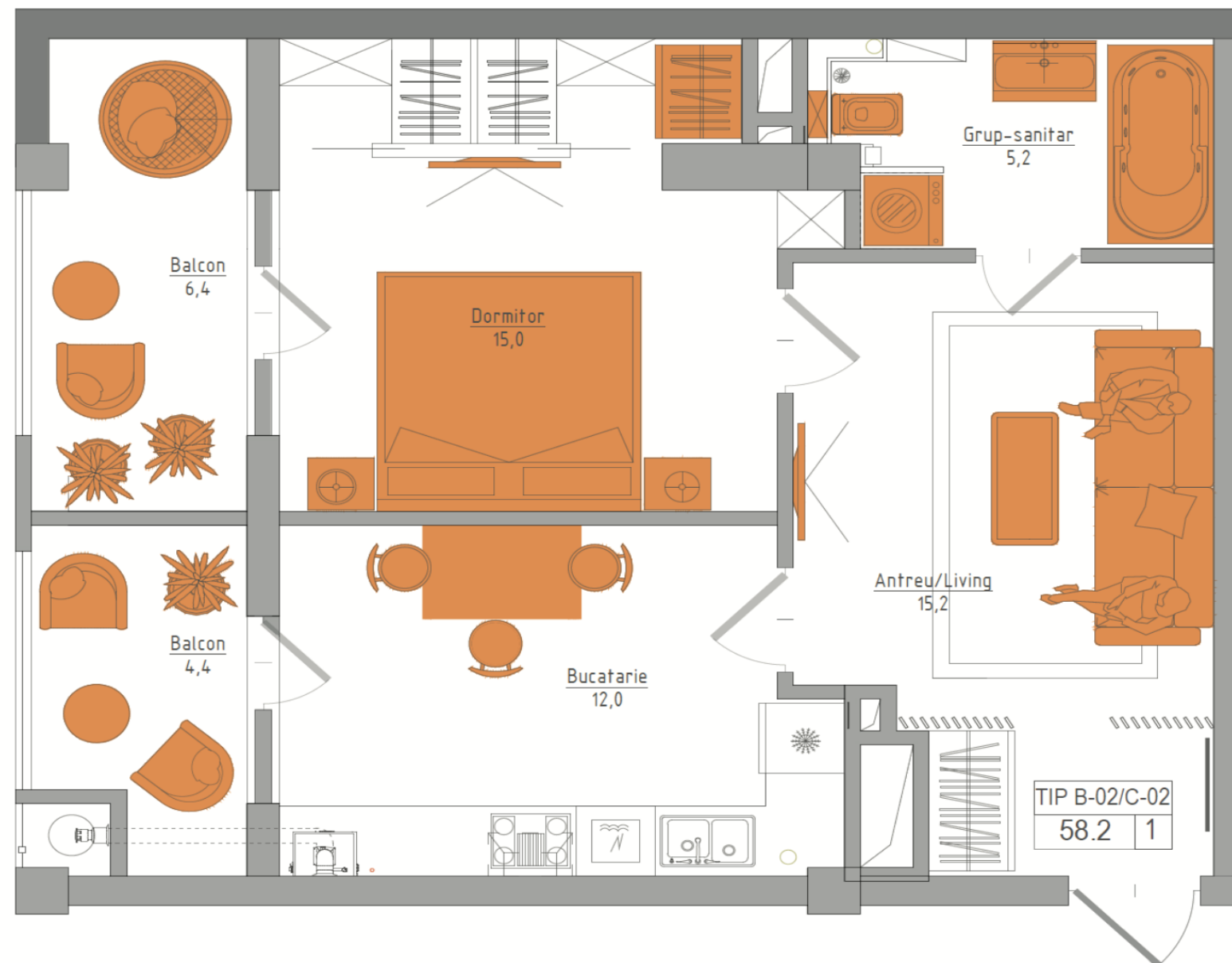

Apartment with 1 room + living

Surface: 58,2 m2



Localizare pe hartă

 ȘOS. HÂNCEȘTI, TELECENTRU, MUN. CHIȘINĂU

Nicolae Pruteanu

079 453 777







