

**STR. IALOVENI, TELECENTRU,  
CHIȘINĂU**

Surface, m2	Rooms
<b>35</b>	<b>1</b>
Floor	Building type
<b>4/12</b>	<b>New building</b>
Real estate condition	Balconies
<b>White variant</b>	<b>1</b>
Heating	Bathrooms
<b>Autonomous</b>	<b>1</b>

Sale  
**41 184 €**



For sale: 1-room apartment – Ialoveni Street, Telecentru sector

New residential complex “Favorit Residence II” – developed by Solomon Construct.

Total area: 34.32 sq.m.

Layout: entrance hall, living room with kitchen, bedroom, bathroom, balcony.

Installment purchase available:

- Down payment of 10%, 30%, 50% or 70%;
- Remaining amount payable over 24 months;
- Payments made every 6 months.

Construction and technical features:

- Reinforced concrete monolithic structure (beams, columns, diaphragms, slabs);
- Masonry from aerated concrete blocks (BCA) 240 mm;
- 100% ventilated facade: ceramic granite with composite decorative elements, insulated with 100 mm mineral wool;
- Panoramic window

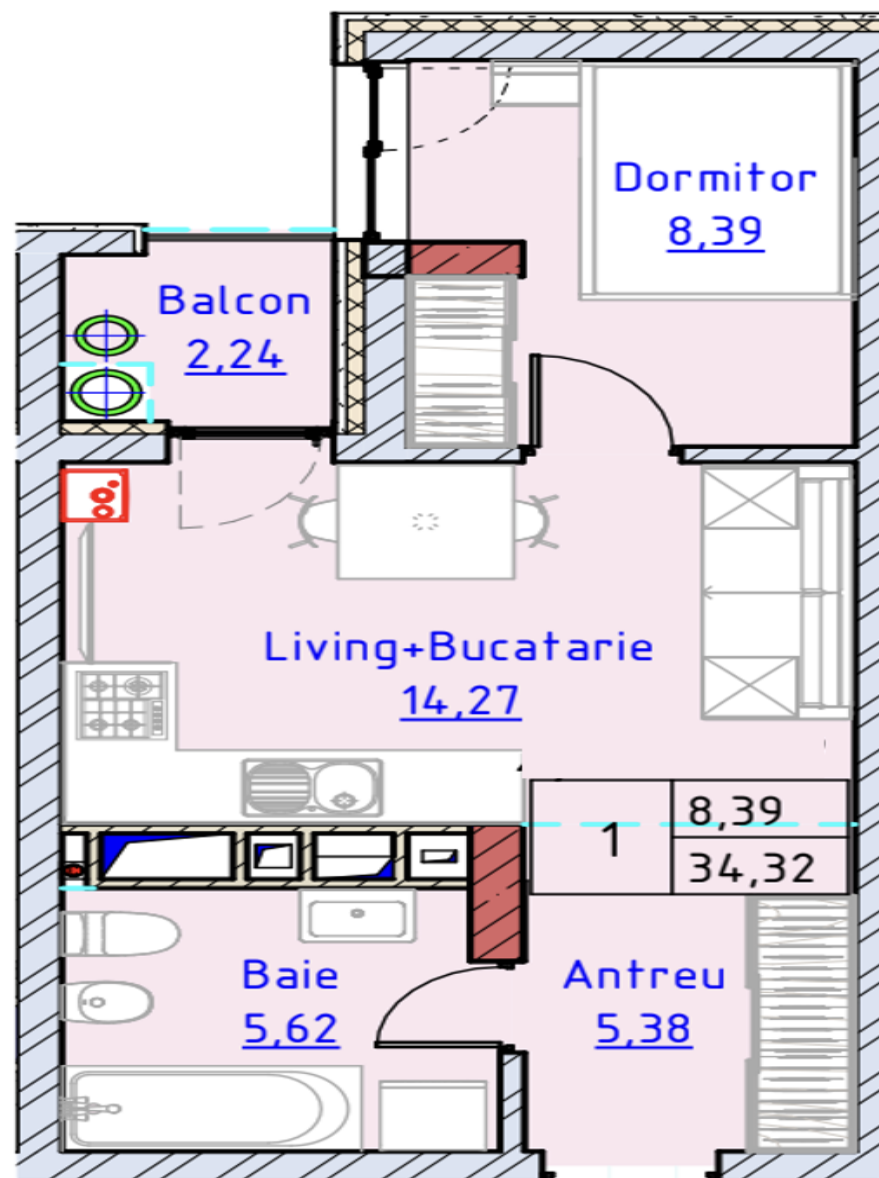

Localizare pe hartă

 STR. IALOVENI, TELECENTRU, CHIŞINĂU

**Daniel Chiru**

**076 001 006**















**mirax**

 STR. TIGHINA, 24

 +37378001717

 [OFFICE@MIRAX.MD](mailto:OFFICE@MIRAX.MD)