

**STR. IALOVENI, TELECENTRU,
CHIȘINĂU**

Surface, m2

43

Floor

1/12

Type

Commercial

Real estate condition

White variant

Sale

62 901 €



Daniel Chiru

076 001 006



Commercial space for sale, located in the basement level in the Telecentru sector, on Ialoveni Street.

Part of the new residential complex "Favorit Residence II" by the construction company "Solomon Construct".

Ideal for investment: office, shop, beauty salon, studio, etc.

Total area: 43.38 m²

Payment in installments:

- Down payment: 10%, 30%, 50%, or 70%;
- Remaining amount payable over 24 months;
- Payments made once every 6 months.

Features:

- Reinforced concrete structure (beams, columns, diaphragms, and slabs);
- 240 mm BCA masonry;
- Ventilated façade finished with granite ceramic tiles, composite decor, and 100 mm mineral wool insulation;
- Pan

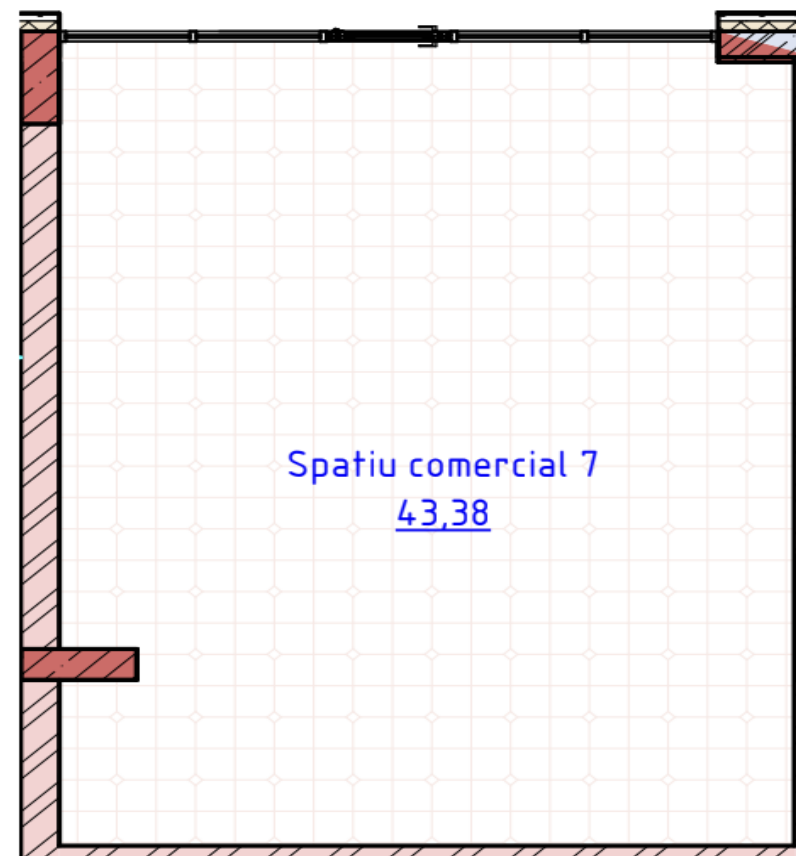

Daniel Chiru

076 001 006



Localizare pe hartă

 STR. IALOVENI, TELECENTRU, CHIŞINĂU

Daniel Chiru

076 001 006









mirax

📍 STR. TIGHINA, 24

☎ +37378001717

✉ OFFICE@MIRAX.MD