

**STR. BARIERA SCULENI, BUIUCANI,
CHIȘINĂU**

Surface, m2

1560

Floor

1/4

Real estate condition

Renovation

Rent

9 300 €



Carolina Buruian

076 610 777



Commercial space for rent, located in the Buiucani sector, with a location directly on the street.

Total area: 1560 sq m

Divided into:

- basement intended for self-service with a separate entrance for each car, it is also intended for production, showroom.

1st floor: - open space, entrance intended for a car, has a separate sanitary block.

2nd floor: open space, sanitary block.

3rd floor: divided into 14 medium-sized cabinets.

The space has euro repair.

Characteristics:

- 4 sanitary block;
- 24/7 access;
- air conditioning unit;
- emergency system;
- euro repair;
- fire protection system;
- outdoor parking;
- developed infrastructure.



Localizare pe hartă

📍 STR. BARIERA SCULENI, BUIUCANI, CHIȘINĂU

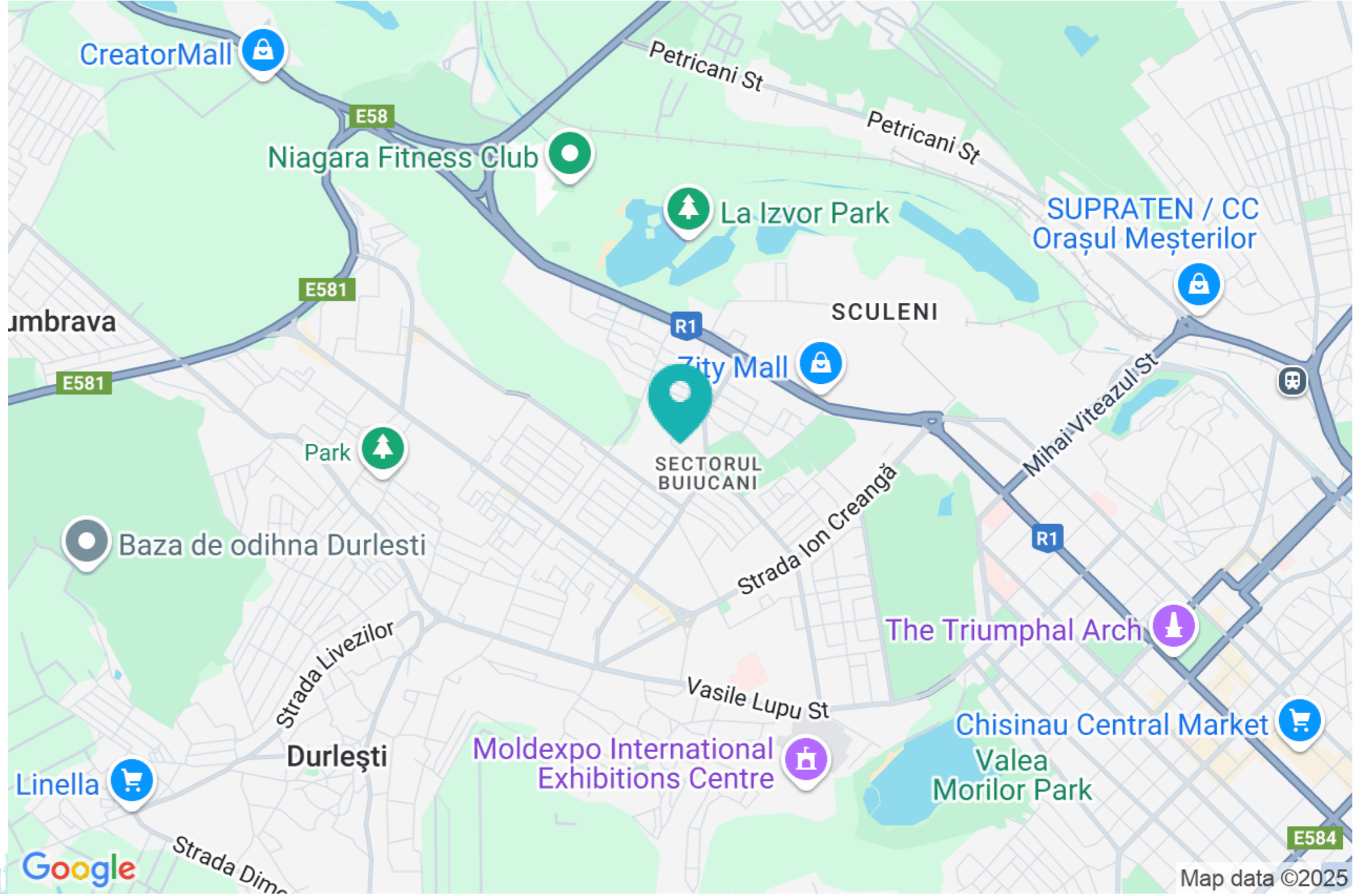

Carolina Buruian

076 610 777





mirax



mirax





mirax



mirax



mirax



mirax



mirax



mirax



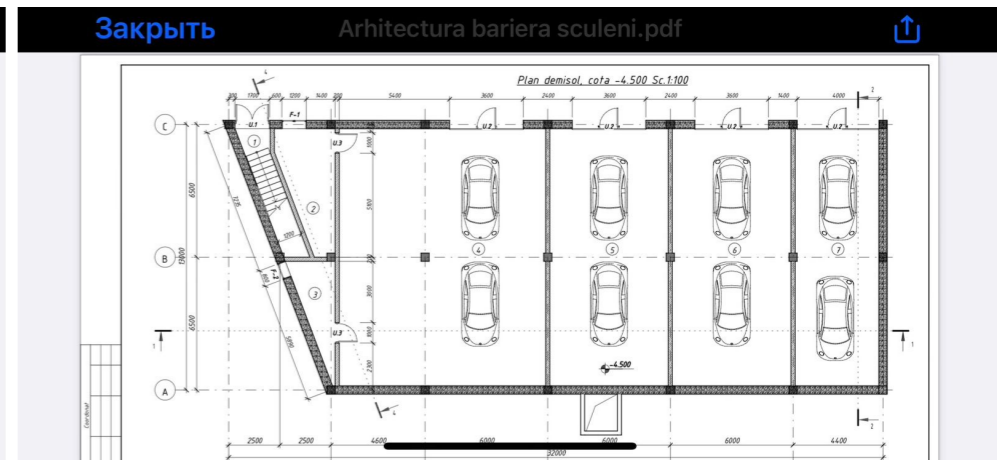
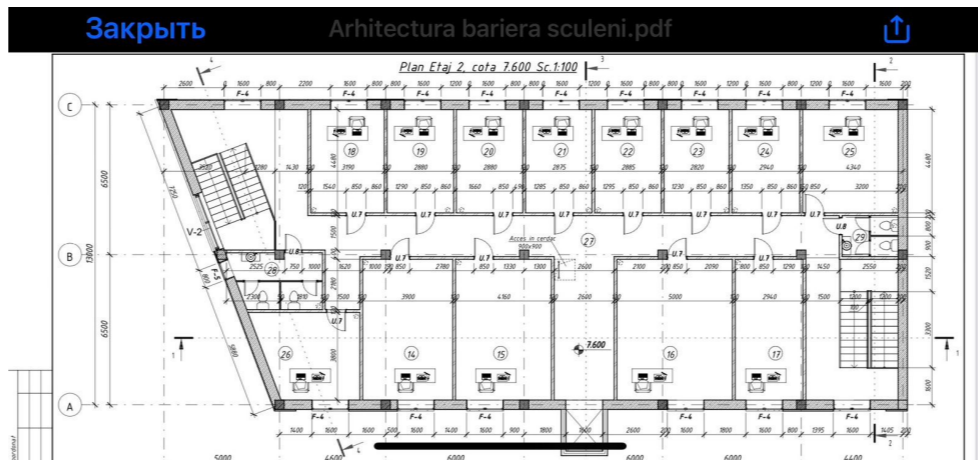
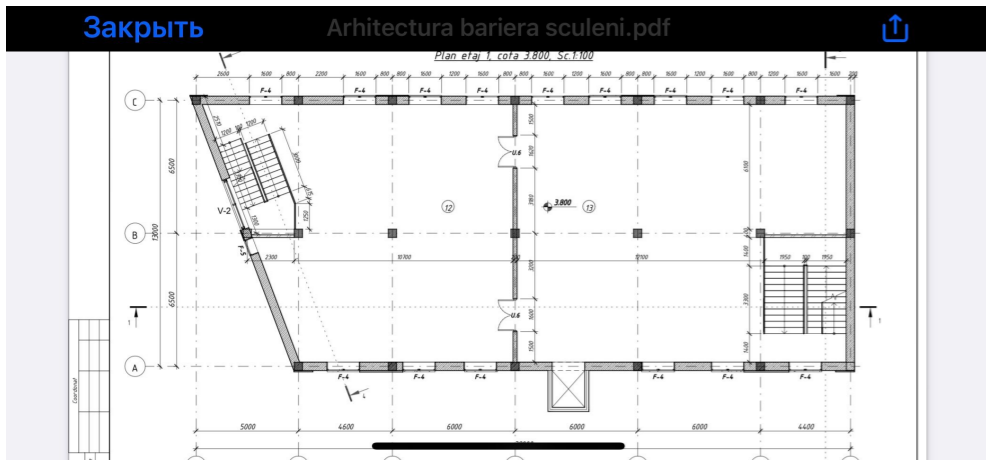
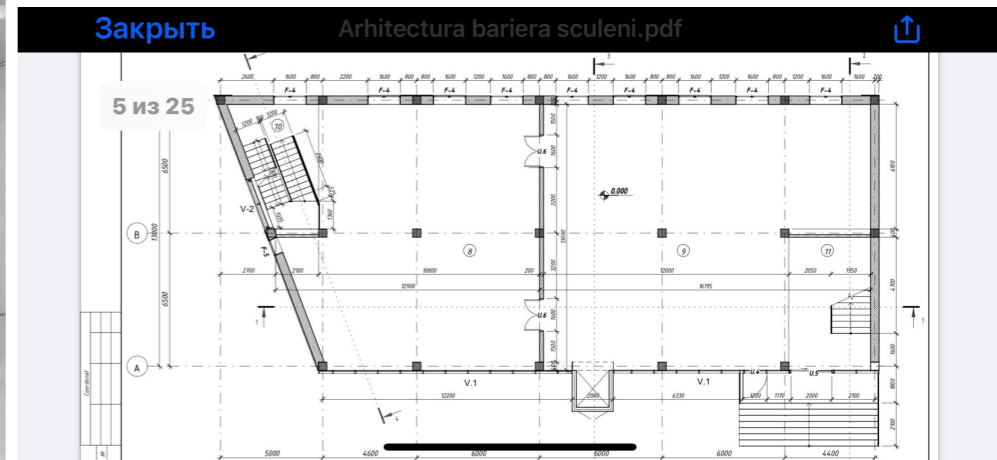

mirax

mirax

📍 STR. 31 AUGUST 1989, 85

☎ 078 27 77 17

✉ OFFICE@MIRAX.MD

📍 STR. 31 AUGUST 1989, 85

☎ 078 27 77 17

✉ OFFICE@MIRAX.MD